

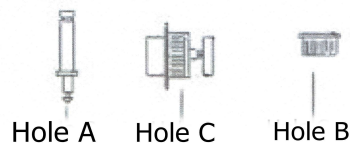

Prokraft PKR EBB / CHBB

PROKRAFT PKR EBB BUTTON CATCH FITTING GUIDE

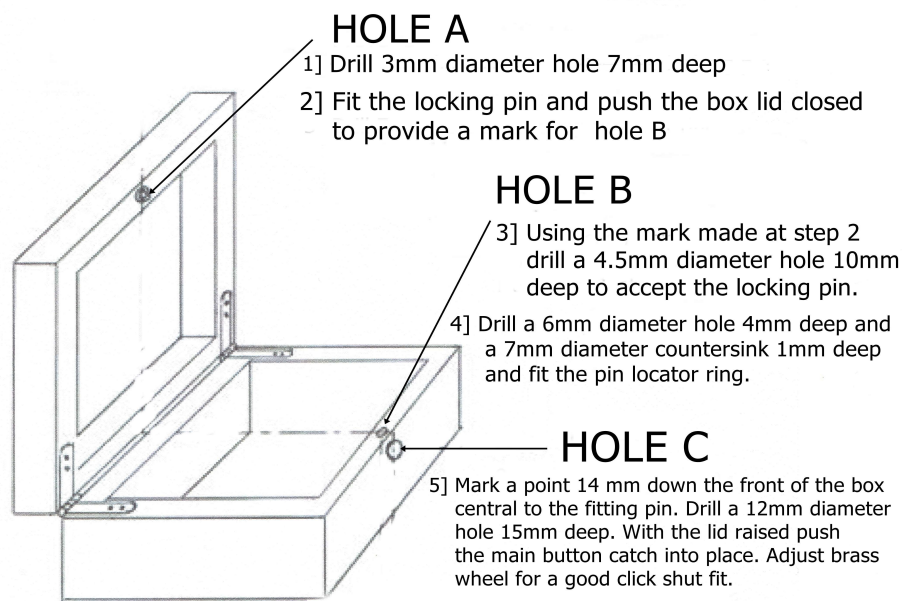

For best results use a drill press. Minimum wall thickness 15mm

Always fit and align hinge mechanisms before fitting box catch.
Follow steps 1 to 5 in order. This is a fitting guide only some minor adjustment may be required for a good final fit. Parts can be glued if required.